

MUNICIPALITY OF CROWSNEST PASS
BYLAW NO. 1025, 2019
ROAD CLOSURE

BEING a bylaw of the MUNICIPALITY OF CROWSNEST PASS for the purpose of closing to public travel and creating title to and disposing of portions of a public highway in accordance with section 22 of the Municipal Government Act, chapter m26, Revised Statutes of Alberta 2000, as amended.

WHEREAS the lands hereafter described are no longer required for public travel,

WHEREAS application has been made to Council to have the roadway closed, and

WHEREAS the Council of the MUNICIPALITY OF CROWSNEST PASS deems it expedient to provide for a bylaw for the purpose of closing to public travel certain roads or portions thereof, situated in the said municipality and thereafter creating title to and disposing of same, and

WHEREAS notice of intention of Council to pass a bylaw has been given in accordance with Section 606 of the Municipal Government Act, and

WHEREAS Council was not petitioned for an opportunity to be heard by any person claiming to be prejudicially affected by the bylaw)

NOW THEREFORE be it resolved that the Council of the MUNICIPALITY OF CROWSNEST PASS in the Province of Alberta does hereby close to public travel and creating title to and disposing of the following described highways, subject to rights of access granted by other legislation.

AREA 'A'

Containing 0.872 Hectares (2.15 Acres) More or Less

All within SW¼ 11-8-4-W5M

EXCEPTING THEREOUT ALL MINES AND MINERALS

As illustrated in Schedule 'A', attached to, and forming part of this bylaw.

READ a **first** time in council this 26 day of March 2019.

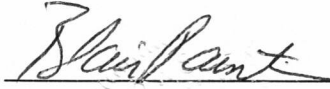

Blair Painter
Mayor



Patrick Thomas
Chief Administrative Officer

APPROVED this 6th day of July, 2020

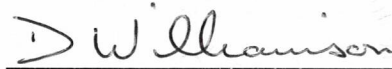

Minister of Transportation

READ a **second** time in council this 15th day of September 2020.

READ a **third and final** time in council this 15th day of September 2020.



Blair Painter
Mayor



Patrick Thomas
Chief Administrative Officer

**BYLAW NO. 1025, 2019
ROAD CLOSURE**

Schedule A

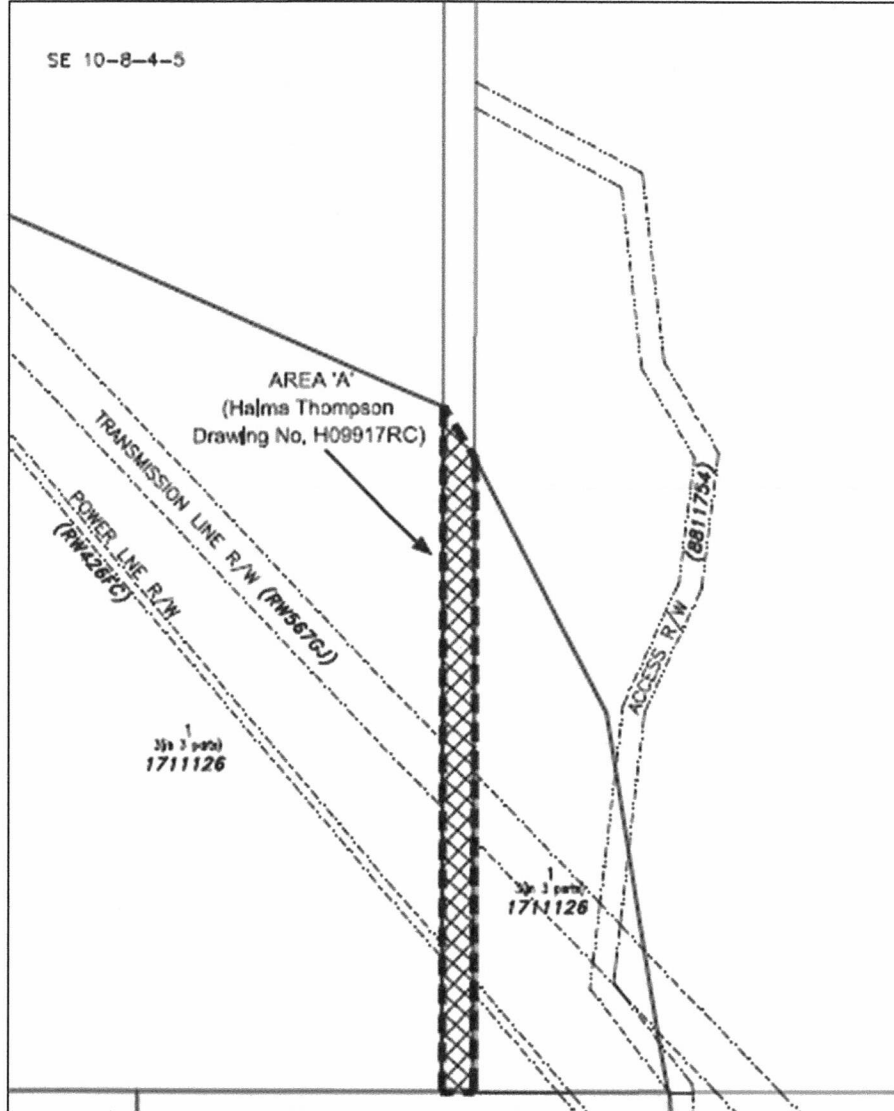

AREA 'A'

Containing 0.872 Hectares (2.15 Acres) More or Less

ALL WITHIN SW¼ 11-8-4 W5M

EXCEPTING THEREOUT ALL MINES AND MINERALS

Road to be closed: 